

2011

Eagle

TRAVEL TRAILERS AND FIFTH WHEELS BY JAYCO



EAGLE SUPER LITE
TRAVEL TRAILER

EAGLE SUPER LITE
FIFTH WHEEL

EAGLE
TRAVEL TRAILER

EAGLE
FIFTH WHEEL



Jayco[®]

AMERICA'S MOST **LIVEABLE** RVs.



TRUE VALUE OF OWNERSHIP

With Jayco, you get more amenities, more liveable, home-like features and superior construction for better durability and greater resale value. **Simply put, you won't find another RV packed with more TRUE VALUE — from the time of purchase to the time you sell.**

- + 2-year warranty
- + more standard features
- + more brand-name components
- + less maintenance
- + better resale value

True Value of Jayco Ownership

Learn more about Jayco's True Value by finding the blue arrows  throughout this brochure.



AMERICA'S MOST LIVEABLE RVs.



CERTIFIED GREEN

All Jayco products are green certified by TRA Certification Inc., an independent, third-party certification agency. Eagle earned gold certification through the use of sustainable materials, environmentally-friendly production methods, energy-efficient components and reduction of waste.



WARRANTY

WE BACK OUR PRODUCTS FOR 2 YEARS. ASK OUR COMPETITION WHY THEY DON'T.

You want your RV to last a long time. And nobody backs their RVs better than we do. Our exclusive two-year Co-Pilot Warranty is the best in the business and provides assurance that you'll enjoy your purchase for many years.



The RV for RV lovers.

The Jayco Eagle is perfect for anyone looking to break away from ordinary RVing without breaking the bank. Whether you choose the travel trailer, fifth wheel or one of our economical Super Lite versions, you'll find Eagle offers more high-end features, more comfort and more amenities than the competition, for the best value. And that's why we say Eagle is the RV for people who love RVing.



↑ MORE LIVEABILITY

With the new adjustable-pitch electric patio awning, you can spend more time outdoors protecting yourself from rain or sun. (Adjustable pitch not available on the Eagle FW).



↑ WATER WORKS SYSTEM

Jayco's innovative 80-plus gallon fresh water system includes a water heater bypass and durable Pex water lines.

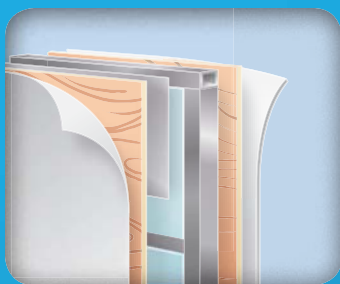

↑ DURABLE CONSTRUCTION

An I-Class structural steel chassis frame, TuffShell vacuum-bonded lamination sidewalls and longitudinal floor joists make Eagle as durable as it is liveable.

Eagle®

TRAVEL TRAILERS AND FIFTH WHEELS BY JAYCO®

EAGLE

Super Lite Series



SUPER LITE
TRAVEL TRAILER

SUPER LITE
FIFTH WHEEL

SUPER LITE, SUPER ROOMY

The Eagle Super Lite travel trailer and Eagle Super Lite fifth wheel feature many of the same amenities and finishing touches as their larger counterparts, but with lower prices they're easier to fit into any RV budget, while their lighter weights make for easier towing.



RETREAT

With a mirrored medicine cabinet, skylight, shower and sink, the Eagle Super Lite bathroom provides a soothing sanctuary to refresh after a day outdoors.

COMFORTABLE

The living areas in the Eagle Super Lite fifth wheels feature a 32" LCD HDTV, J-Steel convertible sofa, overhead cabinetry and residential-style furniture.

EAGLE SUPER LITE FIFTH WHEEL 30.5DBSA | EMERALD





EAGLE SUPER LITE FIFTH WHEEL 30.5DBSA | EMERALD

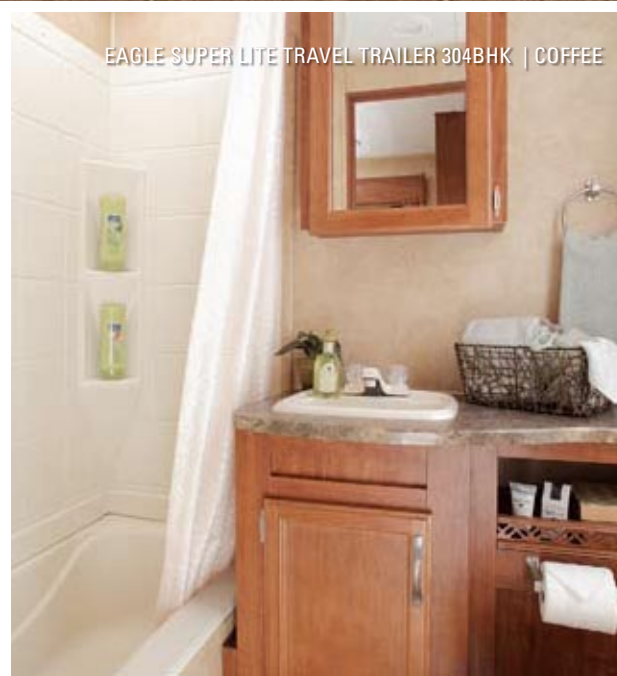

EAGLE SUPER LITE TRAVEL TRAILER 304BHK | COFFEE



EAGLE SUPER LITE TRAVEL TRAILER 304BHK | COFFEE

Eagle Super Lite Series | FLOORPLANS

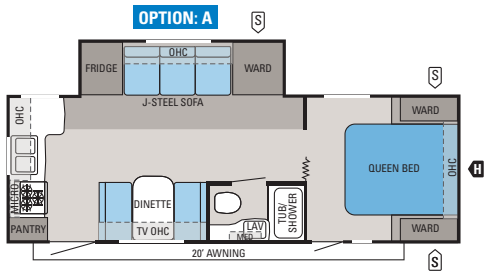

SUPER LITE TRAVEL TRAILER | 256RKS

Ext. Length: 28' 2" Ext. Height: 129" Unloaded Weight (lbs.): 5,915

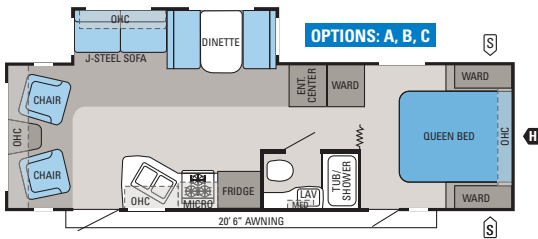

SUPER LITE TRAVEL TRAILER | 298RLS

Ext. Length: 31' 5" Ext. Height: 132" Unloaded Weight (lbs.): 6,185

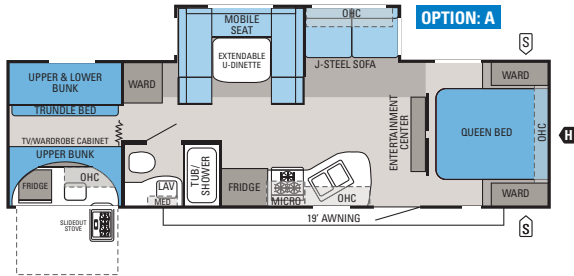

SUPER LITE TRAVEL TRAILER | 304BHK

Ext. Length: 33' 7" Ext. Height: 133" Unloaded Weight (lbs.): 7,030

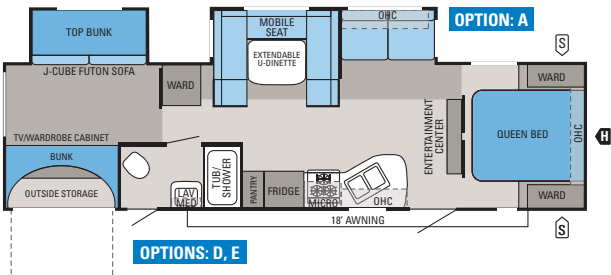

SUPER LITE TRAVEL TRAILER | 314BDS

Ext. Length: 35' 3" Ext. Height: 133" Unloaded Weight (lbs.): 7,590

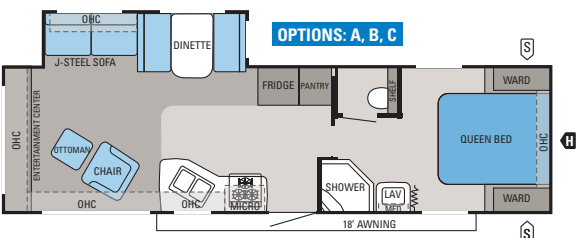

SUPER LITE TRAVEL TRAILER | 318RLS

Ext. Length: 33' 7" Ext. Height: 133" Unloaded Weight (lbs.): 6,715

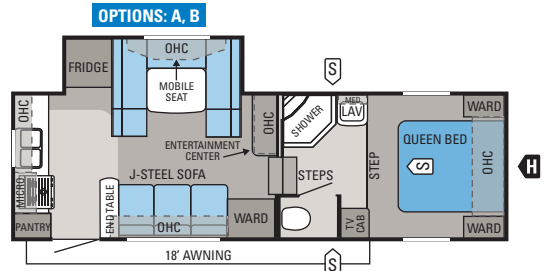

SUPER LITE FIFTH WHEEL | 25.5 RKS

Ext. Length: 29' 2" Ext. Height: 150" Unloaded Weight (lbs.): 7,550

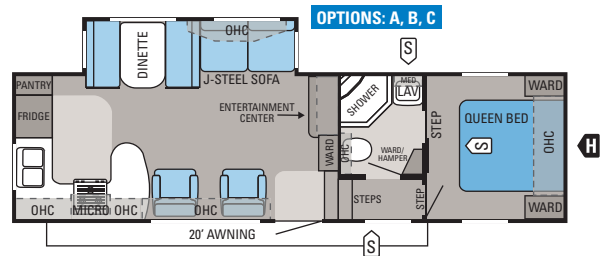

SUPER LITE FIFTH WHEEL | 29.5RKS

Ext. Length: 31' 8" Ext. Height: 151" Unloaded Weight (lbs.): 7,985

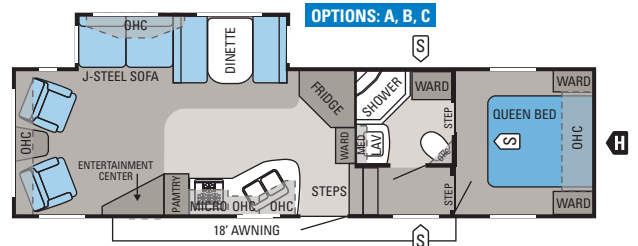

SUPER LITE FIFTH WHEEL | 30.5RKS

Ext. Length: 33' 4" Ext. Height: 152" Unloaded Weight (lbs.): 8,320

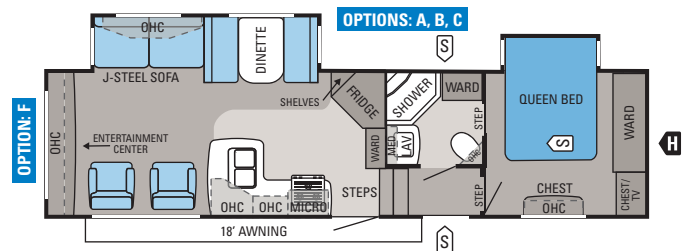

SUPER LITE FIFTH WHEEL | 31.5RLDS

Ext. Length: 34' 7" Ext. Height: 152" Unloaded Weight (lbs.): 8,935

FLOORPLAN OPTIONS

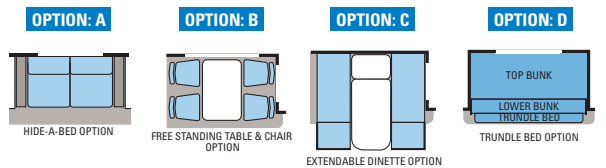

INTERIOR DÉCOR CHOICES

COFFEE

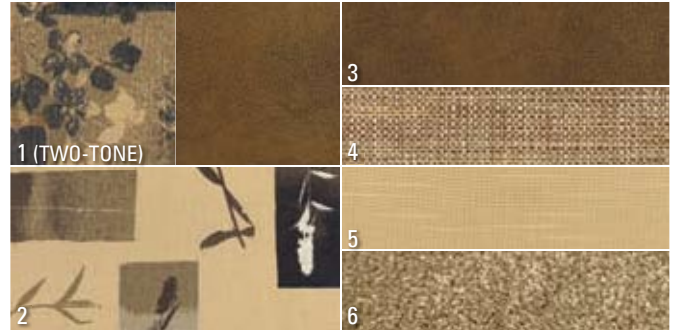

ALMOND



EMERALD



- 1 Sofa
- 2 Bedspread
- 3 Accent fabric
- 4 Chair
- 5 Drapery
- 6 Carpet

WOOD

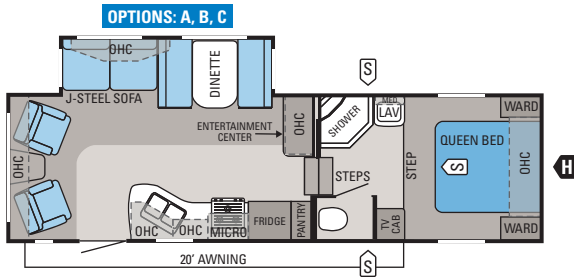

SUPER LITE FIFTH WHEEL | 28.5RLS

Ext. Length: 31' 2" Ext. Height: 151" Unloaded Weight (lbs.): 7,775

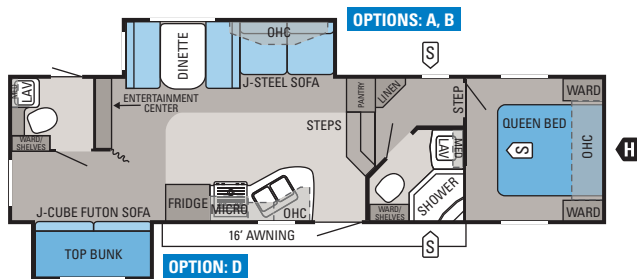

SUPER LITE FIFTH WHEEL | 30.5DBSA

Ext. Length: 34' 2" Ext. Height: 152" Unloaded Weight (lbs.): 9,120

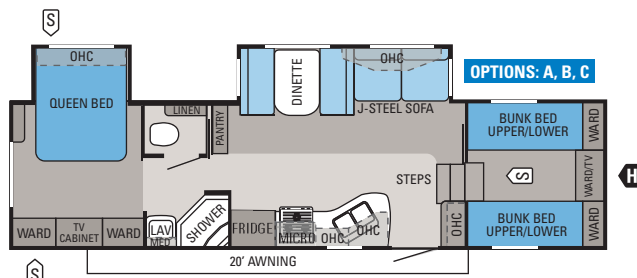

SUPER LITE FIFTH WHEEL | 31.5FBHS

Ext. Length: 34' 2" Ext. Height: 152" Unloaded Weight (lbs.): 8,935

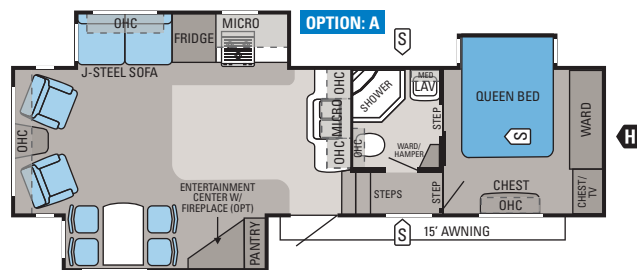

SUPER LITE FIFTH WHEEL | 31.5RLTS

Ext. Length: 34' 1" Ext. Height: 154" Unloaded Weight (lbs.): 9,175*

* Estimate. Visit your Jayco dealer or www.jayco.com for official spec.

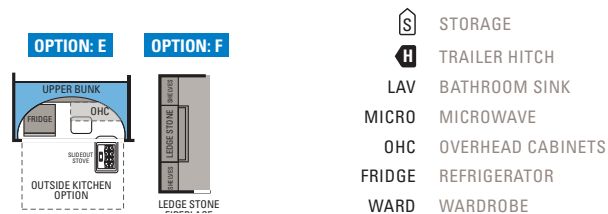

Eagle Super Lite Series | STANDARDS AND OPTIONS

EAGLE SUPER LITE FW
EAGLE SUPER LITE TT

STANDARD BATHROOM EQUIPMENT

| | |
|---|----|
| 6-panel residential-style passage door | •• |
| Glass shower door (select models) | •• |
| Marine toilet with foot flush | •• |
| Medicine cabinet with mirror | •• |
| Shower curtain with curved shower track (select models) | •• |
| Skylight in tub/shower | •• |
| Switches for all lights | •• |
| Toilet paper holder | •• |
| Towel holder | •• |
| Towel ring | •• |
| Vinyl flooring | •• |

STANDARD BEDROOM EQUIPMENT

| | |
|---|----|
| 312-coil innerspring mattress | •• |
| Accordion door to bedroom (select models) | •• |
| Ceiling vent | •• |
| Coordinated, quilted bedspread | •• |
| Decorative headboard | •• |
| Decorative reading lights | •• |
| Hardwood decorative headboard with bookshelf | •• |
| Large pass-through storage (select models) | •• |
| Laundry hamper (select models) | •• |
| Privacy curtains (select models) | •• |
| Shirt wardrobe | •• |
| TV cabinet (select models) | •• |
| Under-bed storage, bed lifts easily on gas struts | •• |

STANDARD KITCHEN EQUIPMENT

| | |
|---|----|
| 3-burner range with 9,000-BTU SuperBurner and piezo igniter | •• |
| 6-cu. ft. flush-mount refrigerator | •• |
| Color-coordinated countertops | •• |
| Concord Cherry raised-panel refrigerator front | •• |
| Deep residential-style double bowl sink | •• |
| Deep storage drawer under booth dinette seat, door on other dinette seat | •• |
| Deep storage drawers under booth dinette | •• |
| Drawer for silverware, divided for utensils | •• |
| Dream Dinette mechanism, raises and lowers dinette tabletop (select models) | •• |
| Extra large picture window at dinette | •• |
| High-rise mixing faucet | •• |
| Mini blind | •• |
| Oversized 21" oven | •• |
| Range hood with light and exhaust fan | •• |
| Sink cover/cutting board (1) | •• |
| Sponge holder under sink | •• |

STANDARD CONSTRUCTION FEATURES

| | |
|--|----|
| 4-1/2" arched truss roof rafters with R-7 insulation | •• |
| 81" ceiling height | •• |
| Aerodynamic wrap-around front fiberglass cap | •• |
| Bead-foam insulation (R-7 sidewalls, R-9 in floor) | •• |
| Electric-powered slideout(s) | •• |
| Frame prepped for bike rack/cargo tray | •• |
| FRP smooth fiberglass sidewall exteriors | •• |

EAGLE SUPER LITE FW
EAGLE SUPER LITE TT

| | |
|--|----|
| Fully decked roof with 3/8" plywood | •• |
| Heated and enclosed fresh water tank and holding tanks | •• |
| I-Class cambered structural steel I-beam frame | •• |
| Pin box, long | •• |
| Platforms for dinette, bed and bunks are constructed of 1/2" plywood | •• |
| Poly Flex one-piece moisture barrier underbelly covering | •• |
| Reflective foil insulation in slideout floors and roof | •• |
| Seamless one-piece rubber roof | •• |
| TuffShell vacuum-bonded laminated sidewalls and floor | •• |
| Welded tubular aluminum floor and sidewall framework | •• |

STANDARD EXTERIOR EQUIPMENT

| | |
|--|----|
| 2-5/16" hitch coupler | •• |
| 15" radial tires | •• |
| ABS fender skirt | •• |
| Adjustable axle hangers | •• |
| Aerodynamic front profile | •• |
| Amber patio light with inside switch | •• |
| Lockable baggage doors, insulated and radius-cornered with heavy-duty grab handles | •• |
| Big Easy entrance step with 10" deep treads | •• |
| Bumper with drain hose carrier and end caps | •• |
| Chrome hub caps | •• |
| Diamond-plated panel on front | •• |
| Electric-powered front jacks | •• |
| Exterior speakers, high-output marine grade (2) | •• |
| E-Z Lube axles | •• |
| Foldable, exterior grab handle | •• |
| Front jacks with quick-release pins | •• |
| Galvanized steel wheel wells | •• |
| MOR/ryde CRE 3000 axle equalizer | •• |
| Outdoor media center | •• |
| Painted bottom radius skirting | •• |
| Pass-through storage compartment | •• |
| Prep for outside grill | •• |
| Rain guttering, molded with extended drip spouts | •• |
| Rear stabilizer jacks (2) | •• |
| Roof ladder | •• |
| Screened egress bunk windows | •• |
| Security light, door side | •• |
| Spare tire with carrier | •• |
| Stabilizer jacks (4) | •• |
| Torq-N-Go wheel nuts | •• |
| White-framed 30" radius-cornered fiberglass main entry door | •• |

STANDARD INTERIOR EQUIPMENT

| | |
|--|----|
| 22" LCD HDTV in living area | •• |
| 26" LCD HDTV in living area (318RLS) | •• |
| 32" LCD HDTV in living area | •• |
| Ball bearing drawer guides 50-lb. capacity with full-drawer extension | •• |
| Cable and satellite TV prepped | •• |
| Concord Cherry raised-panel doors and drawers in kitchen and living area | •• |

EAGLE SUPER LITE FW
EAGLE SUPER LITE TT

| | |
|--|----|
| Concord Cherry raised-panel doors and drawers throughout | •• |
| Crank-up HDTV antenna with signal booster | •• |
| Fabric-covered box valances with lambrequin legs | •• |
| High-intensity 12V lighting package | •• |
| J-Steel convertible sofa | •• |
| Linoleum floor in entryway | •• |
| Nickel cabinet hardware | •• |
| Nickel decorative lighting | •• |
| Overhead cabinetry in slideout room | •• |
| Pleated night shades | •• |
| Residential furniture, designed and made by Jayco | •• |
| Roof-mounted antenna for radio | •• |
| Solid hardwood interior grab handle for main entrance door | •• |
| Swivel rocker(s) (select models) | •• |
| Trackless carpeting with padding | •• |
| Vinyl flooring | •• |
| Wallpaper border | •• |

STANDARD HEAT, POWER & WATER EQUIPMENT

| | |
|--|----|
| 6-gal. gas/electric DSI auto-ignition water heater | •• |
| 12V demand water pump | •• |
| 12V electrical system with deluxe 120V | •• |
| 45-amp power converter (60-amp in 31.5RLDS FW) | •• |
| 30-amp power cord (50-amp in 31.5RLDS FW) | •• |
| 120V G.F.C.I. protected exterior receptacle | •• |
| A/C Chillgrille | •• |
| ABS holding tanks | •• |
| Auto-ignition furnace with wall thermostat | •• |
| Battery box for two batteries | •• |
| Black holding tank sprayer | •• |
| Double 30-lb. propane bottles with regulator | •• |
| Gravity fill for water | •• |
| Hookup for city water | •• |
| In-floor ducted heating | •• |
| Outside shower | •• |
| Rotocast fresh water holding tanks | •• |
| Systems monitor panel | •• |
| Water system winterization kit | •• |

STANDARD SAFETY EQUIPMENT

| | |
|--------------------------------|----|
| Breakaway switch | •• |
| Deadbolt lock on entrance door | •• |
| Dual hitch safety chains | •• |
| Egress window | •• |
| Fire extinguisher | •• |
| Propane/carbon monoxide alarm | •• |
| Smoke alarm | •• |
| Tinted safety-glass windows | •• |

OPTIONS

| | |
|--|----|
| Aluminum rims | •• |
| Bedroom carpet | •• |
| Bike rack/cargo tray system | •• |
| Customer Value Package | •• |
| Customer Value Package with 15,000-BTU A/C | •• |

| | EAGLE SUPER LITE FW | EAGLE SUPER LITE TT |
|---|---------------------|---------------------|
| Electric rear stabilizer jacks | • | • |
| Extendable dinette (select models) | •• | •• |
| Free-standing table with 4 chairs (select models) | •• | •• |
| Hide-a-bed with air mattress | •• | •• |
| Linoleum floor in living area | • | • |
| Outside kitchen (select models) | • | • |
| Portable, outside gas grill | •• | •• |
| Reese Revolution pin box | • | • |
| Roof ladder | • | • |
| Satellite kit | •• | •• |
| Thermal pane tinted safety-glass windows | •• | •• |
| Trundle bed | •• | •• |
| Water purification system | •• | •• |

CUSTOMER VALUE PACKAGE

| | EAGLE SUPER LITE FW | EAGLE SUPER LITE TT |
|---|---------------------|---------------------|
| 2nd 13,500-BTU A/C in bedroom | • | • |
| 6-gal. gas/electric DSI auto-ignition water heater | • | • |
| 13,500-BTU A/C with wall thermostat with louvered directional ceiling vents | •• | •• |
| ABS gas bottle cover | • | • |
| ABS tub surround | •• | •• |
| Bathroom power vent | •• | •• |
| Bi-fold cover for range | •• | •• |
| Carefree Travel'r 12V adjustable pitch electric patio awning | •• | •• |
| Double 30-lb. propane gas bottles with regulator | • | • |
| Innerspring mattress | • | • |

| | EAGLE SUPER LITE FW | EAGLE SUPER LITE TT |
|---|---------------------|---------------------|
| Microwave oven with carousel | •• | •• |
| Multi-Media Premium Sound System | •• | •• |
| AM/FM/CD/DVD stereo with MP3 input jack | •• | •• |
| Outside shower | • | • |
| Oversized oven | • | • |
| Quilted bedspread | • | • |
| Shirt wardrobes in bedroom | • | • |
| Sink cover/cutting board (1) | • | • |
| Skylight in tub/shower | • | • |
| Water heater bypass system | •• | •• |

Eagle Super Lite Series | SPECIFICATIONS

| | FLOORPLAN | EXTERIOR LENGTH | EXTERIOR HEIGHT (WITH A/C) | EXT. HEIGHT (WITH OPT. BEDROOM A/C) | INT. HEIGHT | UNLOADED VEHICLE WEIGHT (LBS.) | DRY HITCH WEIGHT (LBS.) | GROSS VEHICLE WEIGHT RATING (LBS.) | CARGO CARRYING CAPACITY (LBS.) | FRESH WATER CAPACITY (GAL.) (WITH WATER HEATER) | GRAY WASTEWATER CAPACITY (GAL.) | TOILET/BLACK WASTEWATER CAPACITY (GAL.) |
|---------------------------|-----------|-----------------|----------------------------|-------------------------------------|-------------|--------------------------------|-------------------------|------------------------------------|--------------------------------|---|---------------------------------|---|
| SUPER LITE TRAVEL TRAILER | 256RKS | 28' 2" | 129" | — | 81" | 5,915 | 795 | 7,500 | 1,585 | 36.5 | 65 | 32.5 |
| | 298RLS | 31' 5" | 132" | — | 81" | 6,185 | 780 | 7,950 | 1,765 | 36.5 | 32.5 | 32.5 |
| | 304BHK | 33' 7" | 133" | — | 81" | 7,030 | 930 | 8,500 | 1,470 | 36.5 | 32.5 | 32.5 |
| | 314BDS | 35' 3" | 133" | — | 81" | 7,590 | 950 | 9,250 | 1,660 | 36.5 | 32.5 | 32.5 |
| 318RLS | 33' 7" | 133" | — | 81" | 6,715 | 790 | 8,300 | 1,585 | 36.5 | 65 | 32.5 | |
| SUPER LITE FIFTH WHEEL | 25.5RKS | 29' 2" | 150" | — | 72" | 7,550 | 1,465 | 10,000 | 2,450 | 82 | 65 | 32.5 |
| | 28.5RLS | 31' 2" | 151" | — | 77" | 7,775 | 1,650 | 10,200 | 2,425 | 90 | 65 | 32.5 |
| | 29.5RKS | 31' 8" | 151" | — | 72" | 7,985 | 1,625 | 10,700 | 2,715 | 90 | 65 | 32.5 |
| | 30.5DBSA | 34' 2" | 152" | — | 72" | 9,120 | 1,755 | 11,700 | 2,580 | 82 | 65 | 65 |
| | 30.5RLS | 33' 4" | 152" | — | 77" | 8,320 | 1,805 | 11,200 | 2,880 | 82 | 65 | 32.5 |
| | 31.5FBHS | 34' 2" | 152" | — | 68" | 8,935 | 2,135 | 11,700 | 2,765 | 82 | 65 | 32.5 |
| | 31.5RLDS | 34' 7" | 152" | 154" | 72" | 8,935 | 2,135 | 11,700 | 2,765 | 82 | 65 | 32.5 |
| 31.5RLTS | 34' 1" | 154" | 156" | 72" | 9,175* | 1,985* | 11,900 | 2,775* | 82 | 65 | 32.5 | |

* Estimate. Visit your Jayco dealer or www.jayco.com for official spec.

Unloaded Vehicle Weight (UVW): Sometimes referred to as "Dry Weight," UVW means the typical weight of this trailer as built at the factory. The UVW, as used in product literature and other promotional materials, does not include cargo, fresh water, propane, options or dealer-installed accessories.

Gross Vehicle Weight Rating (GVWR): GVWR means the maximum permissible weight of the trailer, including the UVW plus passengers, personal items, all cargo, fluids, options, and dealer-installed accessories. The GVWR is equal to or greater than the sum of the UVW and the CCC.

Cargo Carrying Capacity (CCC): CCC means the maximum weight of all passengers, personal items, food, fresh water, propane, tools, other cargo and dealer-installed accessories that can be carried by the trailer. CCC is equal to or less than GVWR minus UVW. The addition of options will decrease the CCC.

Hitch Weight (HW): The hitch weight, as used in product literature and other promotional materials, does not include cargo, fresh water, propane gas, options or dealer-installed accessories. The addition of these types of items will either add to or subtract from the stated hitch weight.

It is important for your safety and enjoyment that your tow vehicle be adequately sized and equipped to tow and handle the GVWR of the RV you select. Review weights and rating of your tow vehicle and consult a competent advisor for questions or advice. Whether you are new to RVing or a veteran, get a feel for the performance of your tow vehicle before heading out on the roadways. When you tow an RV, you must drive differently than when you drive a single vehicle. Practice hooking up, driving, backing up and braking in a safe environment or seek out professional instruction. Jayco affixes a weight label to each RV which lists weight information for that vehicle. See specifications chart above.

Eagle Series



TRAVEL TRAILER

FIFTH WHEEL

SMART MOVE

If you're looking to move beyond the traditional travel trailer or fifth wheel, then it's time to take a look at the Eagle. Both the Eagle travel trailer and Eagle fifth wheel combine intuitive design, superior construction materials, ample interior space and more name-brand appliances into the perfect home away from home.



MANEUVERABLE

The Eagle fifth wheel's tight-turn radius means it's as easy to park as it is to tow, making it an ideal upgrade from typical fifth wheels.

CONTEMPORARY

You'll love cooking in Eagle's modern kitchen, with Burnished Cherry cabinetry, Dream Dinette, Corian countertops, three-burner stove and deep stainless-steel, residential-style sink.



EAGLE TRAVEL TRAILER 320RLDS | EMERALD





EAGLE FIFTH WHEEL 321RLMS | ALMOND WITH PREMIER INTERIOR PACKAGE



EAGLE FIFTH WHEEL 321RLMS | ALMOND (PREMIER)



EAGLE TRAVEL TRAILER 320RLDS | EMERALD

Eagle Series | FLOORPLANS

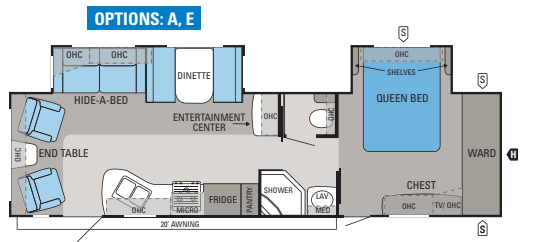

TRAVEL TRAILER | 320RLDS

Ext. Length: 35' 6" Ext. Height: 134" Unloaded Weight (lbs.): 8,115

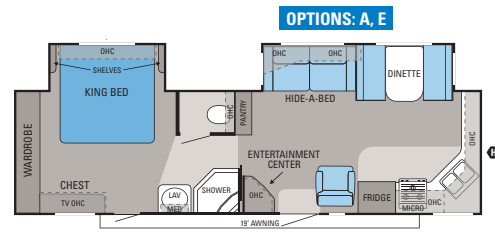

TRAVEL TRAILER | 322FKS

Ext. Length: 33' 11" Ext. Height: 134" Unloaded Weight (lbs.): 7,875

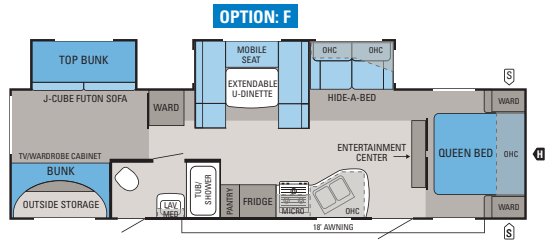

TRAVEL TRAILER | 324BHDS

Ext. Length: 35' 6" Ext. Height: 134" Unloaded Weight (lbs.): 8,000

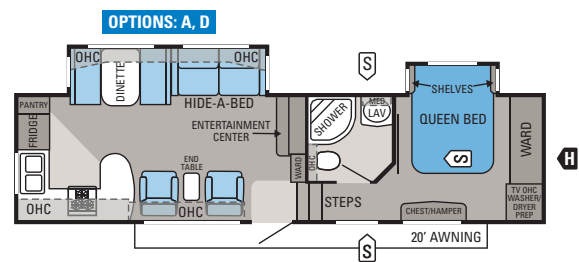

FIFTH WHEEL | 313RKS

Ext. Length: 35' Ext. Height: 152" Unloaded Weight (lbs.): 10,230

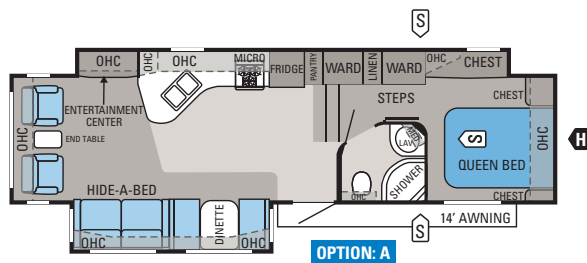

FIFTH WHEEL | 321RLMS

Ext. Length: 35' 10" Ext. Height: 156" Unloaded Weight (lbs.): 11,375

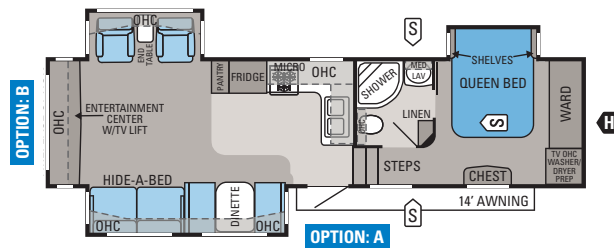

FIFTH WHEEL | 321RLTS

Ext. Length: 35' 4" Ext. Height: 151" Unloaded Weight (lbs.): 10,575

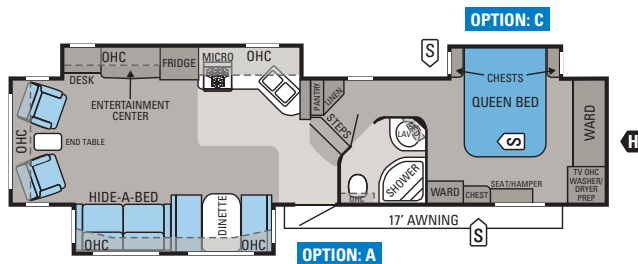

FIFTH WHEEL | 351RLSA

Ext. Length: 39' 1" Ext. Height: 151" Unloaded Weight (lbs.): 11,080

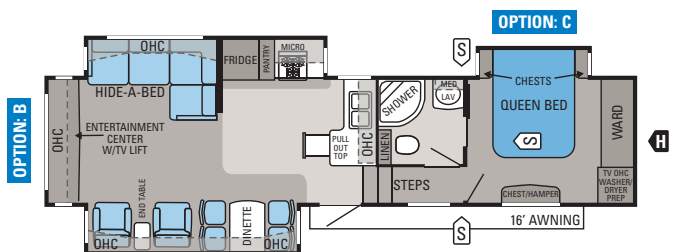

FIFTH WHEEL | 351RLTS

Ext. Length: 38' 6" Ext. Height: 151" Unloaded Weight (lbs.): 11,280

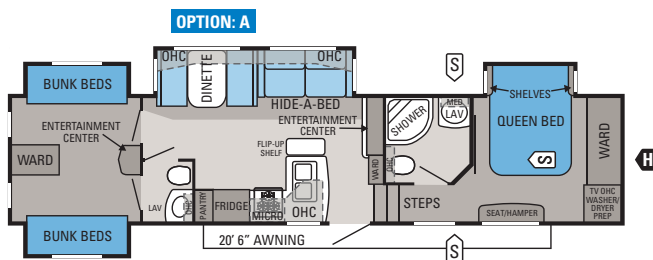

FIFTH WHEEL | 365BHS

Ext. Length: 40' Ext. Height: 160" Unloaded Weight (lbs.): 11,740

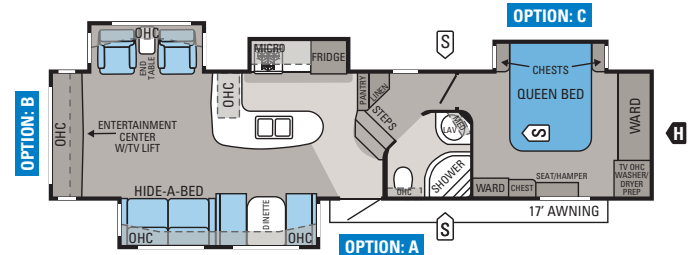

FIFTH WHEEL | 371RLOS

Ext. Length: 39' 4" Ext. Height: 151" Unloaded Weight (lbs.): 11,605

FLOORPLAN OPTIONS

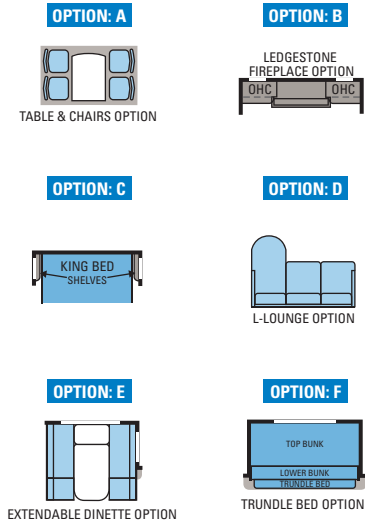

FLOORPLAN KEY

-  STORAGE
-  TRAILER HITCH
- LAV BATHROOM SINK
- MICRO MICROWAVE
- OHC OVERHEAD CABINETS
- FRIDGE REFRIGERATOR
- WARD WARDROBE

INTERIOR DÉCOR CHOICES

COFFEE

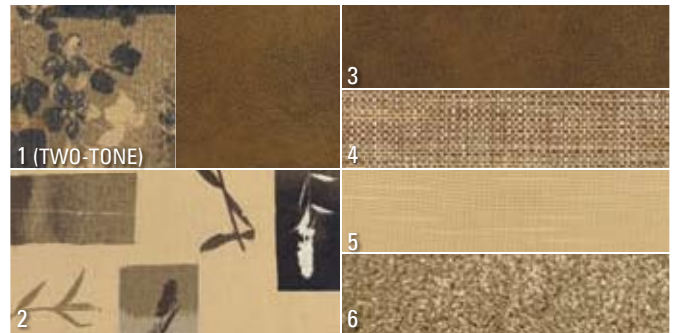

ALMOND



EMERALD



- 1 Sofa
- 3 Accent fabric
- 5 Drapery
- 2 Bedspread
- 4 Chair
- 6 Carpet

WOOD



Eagle Series | STANDARDS AND OPTIONS

| | EAGLE FW EAGLE TT | | EAGLE FW EAGLE TT | | EAGLE FT EAGLE TT |
|--|----------------------|--|----------------------|--|----------------------|
| STANDARD BATHROOM EQUIPMENT | | | | | |
| 6-panel residential-style passage door | •• | Pin box, long | • | Cable and satellite TV prepped | •• |
| ABS tub/shower surround | •• | Platforms for dinette, bed and bunks are constructed of 1/2" plywood | •• | Ceiling fan | • |
| Glass shower door | • | Polar Barrier insulation package | •• | Concord Cherry raised-panel doors and drawers throughout | • |
| Large sink in bathroom | •• | Poly Flex one-piece moisture barrier underbelly covering | •• | Crank-up HDTV antenna with signal booster | •• |
| Marine toilet with foot flush | • | R-21 insulation value in roof, R-8 in sidewalls, R-24 in floor and underbelly, R-15 in slideout floors | • | Fabric-covered box valances with lambrequin legs | •• |
| Medicine cabinet with mirror | •• | Reflective foil insulation in slideout floors and roof | •• | Free-standing end table | • |
| Radius-glass shower door | • | Seamless one-piece rubber roof | •• | Hide-a-bed sofa (air mattress) | •• |
| Switches for all lights | •• | TuffShell vacuum-bonded 5" crowned laminated roof | • | High-intensity 12V lighting package | •• |
| Thetford porcelain toilet with foot flush | • | TuffShell vacuum-bonded laminated sidewalls | • | Linoleum floor in entryway | • |
| Toilet paper holder | •• | TuffShell vacuum-bonded laminated sidewalls and floor | • | Oak trim around main entrance door | • |
| Towel holder | •• | Welded tubular aluminum floor and sidewall framework | • | Overhead cabinetry in slideout room | •• |
| Towel ring | •• | Welded tubular aluminum sidewall framework | • | Pleated day/night shades throughout | •• |
| Vanity light fixture | •• | | | Residential furniture, designed and made by Jayco | •• |
| Vinyl flooring | •• | | | Residential trim package throughout | •• |
| STANDARD BEDROOM EQUIPMENT | | STANDARD EXTERIOR EQUIPMENT | | STANDARD HEAT, POWER & WATER EQUIPMENT | |
| Accordion door to bedroom (select models) | •• | 2-5/16" hitch coupler | • | 12V demand water pump | •• |
| Ceiling vent | •• | 12V hitch light | • | 12V electrical system with deluxe 120V | • |
| Coordinated, quilted bedspread | •• | 15" radial tires | • | 45-amp power converter | • |
| Decorative headboard | •• | 16" radial tires | • | 12V electrical system with deluxe 120V | • |
| Dresser lamp | • | ABS fender skirt | •• | 90-amp power converter | • |
| Large pass-through storage (select models) | • | Amber patio light with inside switch | •• | 30-amp power cord | • |
| Laundry hamper (select models) | • | Lockable baggage doors insulated and radius-cornered with heavy-duty grab handles | •• | 50-amp power cord | • |
| TV cabinet (select models) | •• | Big Easy entrance step with 10" deep treads | •• | 120V G.F.C.I. protected exterior receptacle | •• |
| Under-bed storage, bed lifts easily on gas struts | •• | Bumper with drain hose carrier and end caps | •• | A/C Chillgrille | •• |
| STANDARD KITCHEN EQUIPMENT | | Chrome hub caps | •• | ABS holding tanks | •• |
| 3-burner range with 9,000-BTU SuperBurner and piezo igniter | •• | Cover for propane bottle made of molded ABS | •• | Auto-ignition furnace with wall thermostat | •• |
| 8 cu. ft. flush-mount double-door refrigerator | •• | Dexter Nev-R-Adjust brakes | •• | Battery box for two batteries | • |
| Bi-fold cover for range | •• | Electric front jacks | • | Black holding tank sprayer | •• |
| Color-coordinated countertops | •• | Electric rear stabilizer jacks | • | Double 30-lb. propane bottles with regulator | •• |
| Concord Cherry raised-panel refrigerator front | • | Exterior speakers, high-output marine grade (2) | •• | Gravity fill for water | • |
| Decorative wood spindles on base cabinets | • | E-Z Lube axles | •• | Hookup for city water | • |
| Deep residential-style double bowl sink | •• | Foldable, exterior grab handle | • | In-floor ducted heating | •• |
| Deep storage drawers under booth dinette | •• | Front jacks with quick-release pins | • | Outside shower | •• |
| Drawer for silverware, divided for utensils | • | Galvanized steel wheel wells | •• | Rotocast fresh water holding tanks | • |
| Dream Dinette mechanism, raises and lowers dinette table top (select models) | •• | MaxiStor (select models) | • | Systems monitor panel | •• |
| Extra large picture window at dinette | •• | MOR/ryde CRE 3000 axle equalizer | •• | Uni-Dock utility center, heated and enclosed | • |
| Mini blind | •• | Outdoor media center | • | Water heater bypass system | • |
| Nickel, single-lever kitchen faucet with pull-out sprayer | • | Painted bottom radius skirting | •• | Water system winterization kit | •• |
| Oversized 21" oven | •• | Pass-through storage compartment | • | STANDARD SAFETY EQUIPMENT | |
| Range hood with light and exhaust fan | •• | Prep for outside grill | •• | Breakaway switch | •• |
| Sink cover/cutting board (1) | •• | Rain guttering, molded with extended drip spouts | •• | Deadbolt lock on entrance door | •• |
| Sponge holder under sink | •• | Roof ladder | • | Dual hitch safety chains | • |
| STANDARD CONSTRUCTION FEATURES | | Screened egress bunk windows | •• | Egress window | •• |
| 5/8" tongue-and-groove plywood main floor decking | • | Spare tire with carrier | •• | Fire extinguisher | •• |
| 2" x 3" longitudinal floor studs placed on 16" centers | • | Stabilizer jacks (2 pair) | • | Propane/carbon monoxide alarm | •• |
| 4-1/2" arched truss roof rafters with R-7 insulation | • | Stor-Galore basement storage | • | Smoke alarm | •• |
| 81" ceiling height | • | Torq-N-Go wheel nuts | •• | Tinted safety-glass windows | •• |
| Aerodynamic wrap-around front fiberglass cap | •• | White-framed 30" radius-cornered fiberglass main entry door | •• | STANDARD INTERIOR EQUIPMENT | |
| Cabinetry crafted with screwed-stile construction | •• | | | 32" LCD HDTV in living area | •• |
| Electric-powered slideout | •• | | | Antique nickel cabinet hardware | •• |
| Frame prepped for bike rack/cargo tray | •• | | | Antique nickel lighting at sofa and dinette | •• |
| FRP smooth fiberglass sidewall exteriors | •• | | | Arched step treads into bathroom | • |
| Fully decked roof with 1/4" plywood | • | | | Ball bearing drawer guides 75-lb. capacity with full-drawer extension | • |
| Fully decked roof with 3/8" plywood | • | | | Ball bearing drawer guides 100-lb. capacity with full-drawer extension | • |
| Heated and enclosed fresh water tank and holding tanks | •• | | | Cabinet door hinges, hidden throughout | • |
| I-Class cambered structural steel I-beam frame | •• | | | | |

OPTIONS

| | EAGLE FW | EAGLE TT |
|--|----------|----------|
| 2 rocker recliners in lieu of 2 swivel rockers (select models) | • | • |
| 2nd 13,500-BTU A/C in bedroom | • | • |
| 40" LCD HDTV in lieu of 32" LCD HDTV | • | • |
| 5,500-watt generator (generator prep included) | • | • |
| Bike rack/cargo tray system | •• | •• |
| CD stereo in bunk | • | • |
| Customer Value Package | •• | •• |
| Customer Value Package with 15,000-BTU A/C | • | • |
| Electric stabilizer jacks (4) | • | • |
| Electric tongue jack | • | • |
| Extendable dinette (select models) | • | • |
| Fireplace with Ledgestone façade | • | • |
| Free-standing table with 4 chairs (select models) | •• | •• |
| Generator prep | • | • |
| Key fob remote control | • | • |
| King bed (select models) | • | • |
| Linoleum in living area | •• | •• |
| Portable, outside gas grill | •• | •• |
| Premier Interior Package | • | • |
| Rocker recliner in lieu of swivel rocker | • | • |
| Roof ladder | • | • |

| | EAGLE FW | EAGLE TT |
|---|----------|----------|
| Satellite kit | •• | •• |
| Slideout awning | • | • |
| Slideout awning above door | •• | •• |
| Slideout awnings | •• | •• |
| Sofa | • | • |
| Thermal pane tinted safety-glass windows | •• | •• |
| Trundle bed option (select models) | • | • |
| Burnished hardwood slideout fascia boards | • | • |

PREMIER INTERIOR PACKAGE

| | |
|--|---|
| ↑ Burnished Cherry cabinetry | • |
| ↑ Corian high-gloss kitchen countertop with sink cover inserts | • |
| Nickel single-lever kitchen faucet with pull-out sprayer | • |
| Power lift vent in living room and/or rear bedroom | • |
| Recessed halogen ceiling lights | • |
| Rustic plank wood-grain vinyl flooring in kitchen and bath | • |
| ↑ Stainless-steel under-mount kitchen sink | • |
| Upgraded bedding package | • |
| Upgraded hide-a-bed sofa with air mattress | • |

CUSTOMER VALUE PACKAGE

| | |
|---|---|
| ↑ 10-gal. gas/electric DSI auto-ignition water heater | • |
| ↑ 12-gal. gas/electric DSI auto-ignition water heater | • |

| | EAGLE FW | EAGLE TT |
|---|----------|----------|
| 13,500-BTU A/C with wall thermostat with louvered directional ceiling vents | • | • |
| 15,000-BTU A/C with louvered and directional ceiling vents | • | • |
| ↑ Aluminum rims | • | • |
| Bathroom power vent | •• | •• |
| Burnished hardwood slideout fascia boards | • | • |
| ↑ Carefree Travel'r 12V adjustable pitch electric patio awning | • | • |
| Carefree Travel'r 12V electric patio awning | • | • |
| Deluxe pillowtop mattress | •• | •• |
| ↑ Floor-mounted safe | • | • |
| Foldable, exterior grab handle | •• | •• |
| Microwave oven with carousel | •• | •• |
| ↑ Multi-Media Premium Sound System AM/FM/CD/DVD/stereo with MP3 input jack | •• | •• |
| Security lights (2) | •• | •• |
| Skylight in tub/shower | •• | •• |
| Vacuum-bonded 5" crowned laminated roof with R-21 insulation value | • | • |
| Water heater bypass system | • | • |
| Water purifier | •• | •• |

Eagle Series | SPECIFICATIONS

| | FLOORPLAN | EXTERIOR LENGTH | EXTERIOR HEIGHT (WITH A/C) | EXT. HEIGHT (WITH OPT. BEDROOM A/C) | INTERIOR HEIGHT | UNLOADED VEHICLE WEIGHT (LBS.) | DRY HITCH WEIGHT (LBS.) | GROSS VEHICLE WEIGHT (LBS.) | CARGO CARRYING CAPACITY (LBS.) | FRESH WATER | GRAY | TOILET/BLACK |
|----------------|-----------|-----------------|----------------------------|-------------------------------------|-----------------|--------------------------------|-------------------------|-----------------------------|--------------------------------|-------------------------------------|----------------------------|----------------------------|
| | | | | | | | | | | CAPACITY (GAL.) (WITH WATER HEATER) | WASTEWATER CAPACITY (GAL.) | WASTEWATER CAPACITY (GAL.) |
| TRAVEL TRAILER | 320RLDS | 35' 6" | 134" | — | 81" | 8,115 | 1,215 | 10,500 | 2,385 | 90 | 37 | 37 |
| | 322FKS | 33' 11" | 134" | — | 81" | 7,875 | 1,160 | 10,250 | 2,375 | 90 | 85.5 | 48.5 |
| | 324BHDS | 35' 6" | 134" | — | 81" | 8,000 | 1,025 | 10,250 | 2,250 | 90 | 37 | 37 |
| FIFTH WHEEL | 313RKS | 35' | 152" | 160" | 77" | 10,230 | 2,345 | 14,000 | 3,770 | 87 | 89 | 52 |
| | 321RLMS | 35' 10" | 156" | 162" | 77" | 11,375 | 2,350 | 14,750 | 3,375 | 87 | 52 | 52 |
| | 321RLTS | 35' 4" | 151" | 160" | 77" | 10,575 | 2,225 | 14,500 | 3,925 | 87 | 89 | 52 |
| | 351RLSA | 39' 1" | 151" | 158" | 77" | 11,080 | 2,435 | 14,950 | 3,870 | 87 | 87 | 52 |
| | 351RLTS | 38' 6" | 151" | 160" | 77" | 11,280 | 2,250 | 15,250 | 3,970 | 87 | 87 | 52 |
| | 365BHS | 40' | 160" | 160" | 77" | 11,740 | 2,340 | 15,800 | 4,060 | 87 | 89 | 89 |
| | 371RLQS | 39' 4" | 151" | 160" | 77" | 11,605 | 2,335 | 15,500 | 3,895 | 87 | 87 | 52 |

Unloaded Vehicle Weight (UVW): Sometimes referred to as "Dry Weight," UVW means the typical weight of this trailer as built at the factory. The UVW, as used in product literature and other promotional materials, does not include cargo, fresh water, propane, options or dealer-installed accessories.

Gross Vehicle Weight Rating (GVWR): GVWR means the maximum permissible weight of the trailer, including the UVW plus passengers, personal items, all cargo, fluids, options, and dealer-installed accessories. The GVWR is equal to or greater than the sum of the UVW and the CCC.

Cargo Carrying Capacity (CCC): CCC means the maximum weight of all passengers, personal items, food, fresh water, propane, tools, other cargo and dealer-installed accessories that can be carried by the trailer. CCC is equal to or less than GVWR minus UVW. The addition of options will decrease the CCC.

Hitch Weight (HW): The hitch weight, as used in product literature and other promotional materials, does not include cargo, fresh water, propane gas, options or dealer-installed accessories. The addition of these types of items will either add to or subtract from the stated hitch weight.

It is important for your safety and enjoyment that your tow vehicle be adequately sized and equipped to tow and handle the GVWR of the RV you select. Review weights and rating of your tow vehicle and consult a competent advisor for questions or advice. Whether you are new to RVing or a veteran, get a feel for the performance of your tow vehicle before heading out on the roadways. When you tow an RV, you must drive differently than when you drive a single vehicle. Practice hooking up, driving, backing up and braking in a safe environment or seek out professional instruction. Jayco affixes a weight label to each RV which lists weight information for that vehicle. See specifications chart above.

↑ LIVEABLE FEATURES AND AMENITIES

Every Jayco comes packed with features and amenities designed to make your life easier and family time more enjoyable.



RAISED-PANEL CABINERY

Concord Cherry or Burnished Cherry cabinets and nickel hardware add to Eagle's home-like atmosphere.



OUTSIDE KITCHEN

Spend even more time outdoors with Eagle's optional outside kitchen, complete with stove, refrigerator, sink and storage space (select models).



BALL BEARING GUIDES

Our residential-style ball bearing drawer guides provide smooth operation and full-drawer extension.



HIDE-A-BED SOFA

There's plenty of room for company thanks to a hide-a-bed sofa with air mattress and blanket drawer (optional in Super Lite models).



A TRADITION OF LIVEABILITY

Starting with our first lifter system for fold-down campers in 1968, which made for an easier, more enjoyable camping experience, Jayco has always been about liveability. Today, we're the world's largest family-owned RV manufacturer, yet our priorities remain the same: making RVs more liveable and family time more memorable.

www.jayco.com



NORCOLD REFRIGERATOR

A spacious refrigerator lets you bring along everything you need for a great home-cooked meal.

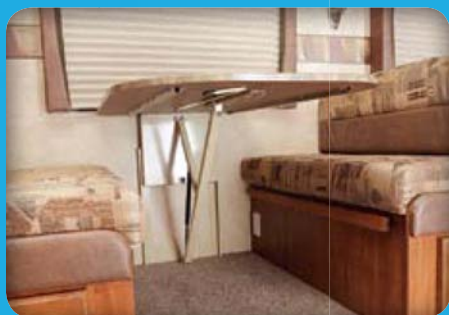

DREAM DINETTE

Easily raise and lower your tabletop or extend it out with an optional 12" leaf and support leg (most models).



TRUE VALUE OF OWNERSHIP

With Jayco, you get more amenities, more liveable, home-like features and superior construction for longer durability and a better resale value. Simply put, you won't find another RV packed with more *true value*—from the time of purchase to the time you sell. Don't believe us? Run through this list. The check marks don't lie.

US THEM **2011 EAGLE**

- 2-year industry-leading Co-Pilot warranty
- MOR/ryde CRE 3000 rubberized suspension
- Astrofoil insulation
- Nev-R-Adjust brakes with Torq-n-Go lug nuts (select models)
- Goodyear brand radial tires
- Polar Barrier insulation package (Eagle fifth wheel)
- I-Class structural steel I-beam frame
- Full-extension ball bearing drawer guides throughout
- 32" HDTV with 180-degree viewing (select models)
- Dream Dinette table mechanism (select models)



AMERICA'S MOST **LIVEABLE** RVs.

↑ JAYCO CONSTRUCTION

At Jayco, we've built a reputation for superior construction and craftsmanship. We always use top-quality materials and production techniques, giving our products reliable resale value and our owners peace of mind.



INSIDE THE ENGINEERING | Eagle Travel Trailer and Super Lite Series

Much of what gives a Jayco its reputation for durability and strength is inside the walls and under the chassis. The Eagle Super Lites and the Eagle travel trailers feature ① an aerodynamic front profile (Super Lite fifth wheels only), ② MOR/ryde CRE 3000 suspension, ③ an enclosed and heated underbelly, ④ Torq-N-Go wheel nuts with Dexter Nev-R-Adjust brakes (Eagle travel trailers only) and ⑤ an I-Class structural steel I-beam frame.

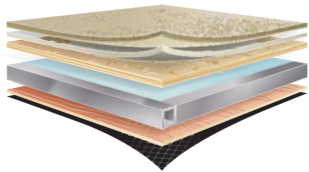

FLOOR

Vacuum-bonded lamination joins our welded aluminum frame with bead-foam insulation (R-9) and decking to create one of the industry's strongest foundations.



WALLS

TuffShell vacuum-bonded lamination combines welded aluminum frames, metal backings, decorative interior wall panels and fiberglass exterior siding, creating a durable structure designed to withstand use and travel.

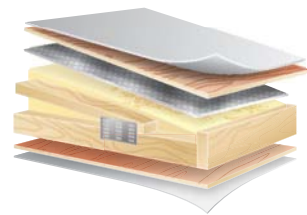

ROOF

A combination of $\frac{3}{8}$ " plywood decking, wood rafters with $4 \frac{1}{2}$ " arched trusses, foil insulation (R-22) and a seamless rubber shield protect against moisture and resist aging.



POLAR BARRIER PACKAGE

Our exclusive Polar Barrier thermal insulation package lets you extend the camping season by providing protection against freezing (temperatures as low as 0°F or -17°C), greatly increasing your options for winter travel destinations (Eagle FW only).

*The Jayco Eagle FW was tested in 0°F (-17°C) weather over an extended period of time in a controlled environment and all functions of the coach were fully operational. Testing cannot account for natural elements, such as wind or moisture. In actual use, unit may not perform as well. In addition, outside components are subject to freezing and require steps to properly insulate. Jayco's warranty does not cover damage caused by freezing.



INSIDE THE ENGINEERING | Eagle Fifth Wheel

Much of what gives a Jayco its reputation for durability and strength is in the details. The Eagle fifth wheel features **1** an aerodynamic Eurostyle front cap, **2** Nev-R-Adjust brakes with Torq-n-Go lug nuts, **3** MOR/ryde CRE 3000 suspension, **4** an enclosed and heated underbelly, **5** Goodyear brand radial tires and **6** an I-Class structural steel I-beam frame.

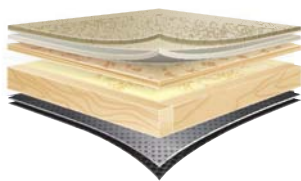

FLOOR

A $\frac{5}{8}$ " tongue-and-groove plywood deck on 2" x 3" wooden floor joists, together with fiberglass and foil insulation (R-24) and a Poly Flex covering, creates one of the strongest foundations in the industry.

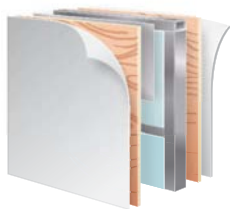

WALLS

TuffShell vacuum-bonded lamination combines welded aluminum frames, metal backers, decorative interior wall panels and fiberglass exterior siding, creating a durable structure designed to withstand use and travel.

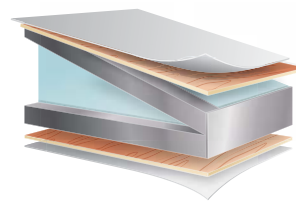

ROOF

The laminated, vacuum-bonded roof is topped off with $\frac{1}{4}$ " plywood decking on 5" arched aluminum trusses with bead-foam insulation (R-21) and a seamless rubber shield that protects against moisture and resists aging.

↑ JAYCO CRAFTSMANSHIP

Jayco's dedicated production team includes Amish craftsmen who build with well-honed woodworking techniques passed down for generations and skilled seamstresses who produce our upholstery, bedding and draperies with great attention to detail.





AMERICA'S MOST **LIVEABLE** RVs.



INDUSTRY-LEADING WARRANTY

The Jayco Co-Pilot Warranty is a manufacturer's limited warranty. It comes from the people who build Jayco recreation vehicles to the people who buy them. Each Jayco is warranted to the original purchaser for twenty-four (24) months or twenty-four thousand (24,000) miles (mileage limitation applies to motorized products only), whichever occurs first, from the original date of purchase against defects in materials and workmanship. Jayco's limited warranty is not transferable. Go ahead and compare the Jayco warranty with other manufacturers' warranties. You'll find it's the best in the business!

For a copy of the limited warranty with full terms and conditions, ask your local Jayco dealer.



OVER 300 LOCAL DEALERS

Establishing a solid relationship with your local Jayco dealer is a key component in the enjoyment of your new Jayco. By purchasing from a local dealer, you will have a convenient location for sales, parts and service support.

Jayco dealers are required to deliver all products at the site of the sale to provide a full product orientation and walkthrough at the time of delivery. It's a good way to become familiar with your Jayco and to meet the service, parts and warranty staff members who will be assisting you. If you live in Canada, there are regulations that must be met when buying a Jayco RV. Your local Canadian dealer is a professional at meeting these requirements and regulations. There simply is no substitute for a good relationship with your local Jayco dealer.



1-YEAR ROADSIDE ASSISTANCE

Travel worry-free with Jayco's Customer First Roadside Assistance program, yours at no cost during your first year of ownership. This program is offered through Coach-Net, the largest RV emergency road service in the country, and gives you immediate access to dependable roadside assistance and support services with a simple phone call.

- Free jump starts
- Free tire changes
- Free fuel delivery
- Free lockout service
- Free travelers checks
- Toll-free nationwide service appointment assistance
- 24-hour toll-free emergency message service
- Free custom trip routing and full-color map service
- Free dispatch of on-site mechanical service
- \$2,000 trip-interruption reimbursement
- RV technical assistance hotline
- Free towing to nearest qualified service

Your Jayco Dealer



Jayco proudly sponsors Tread Lightly!, a nonprofit organization whose mission is to empower generations to enjoy the outdoors responsibly through education and restoration.



From RV insurance to extended warranties, JayPlus has it covered. Ask your Jayco dealer about our exclusive JayPlus program today.



As a Jayco owner, you can be part of the Jayco Jafari International Travel Club. Ask your dealer about the Jafari "flight" in your area, write Jayco or visit our website.

Jayco, Inc., P.O. Box 460, Middlebury, IN 46540, www.jayco.com © **RVIA**

See dealer for further information and prices. All information in this brochure is the latest available at the time of publication approval. Jayco reserves the right to make changes and to discontinue models without notice or obligation. Photos in this brochure may show optional equipment and props for photography purposes. RVs built for sale in Canada may differ to conform to Canadian codes. ©2010 Jayco, Inc. 11-EAGL-PL 0610-100K Printed in U.S.A.